

ASCENSION CLARITY MODEL SERIES VERTICAL PLATFORM WHEELCHAIR LIFT WITH RUNWAY ENCLOSURE

1. CODE COMPLIANCE: ASME A18.1, ASME A17.5, ANSI A117.1, ADAAG, NFPA 70 (NEC).
2. RATINGS
 - 2.1 CAPACITY: 750 LB
 - 2.2 SPEED: 20 FT/MIN
 - 2.3 DUTY: 168 CYCLE-FT/HOUR (12 CYCLES/HOUR MINIMUM).
 - 2.4 TRAVEL: 35.00 TO 168.00 AS ALLOWED BY AHJ.
3. DRIVE & ELECTRICAL
 - 3.1 DRIVE TYPE: 2:1 CHAIN HYDRAULIC
 - 3.2 SUSPENSION: 4X #50 ANSI ROLLER CHAINS
 - 3.3 MOTOR: 24VDC, 3 HP
 - 3.4 120VAC, 60 HZ, 10A, 1-PHASE.
 - 3.5 ALL CONTROL CIRCUITS 24VDC.
 - 3.6 BATTERY BACKUP PROVIDED STANDARD.
 - 3.7 MANUAL LOWERING PULL HANDLE WITH ACCESS LOCK PROVIDED STANDARD AT UPPER LANDING.
4. SITE CONSIDERATIONS
 - 4.1 DO NOT PROVIDE PIT OR RAMP. LOW-PROFILE PLATFORM FLOOR MEETS ADA REQUIREMENTS AS ENTRY THRESHOLD.
 - 4.2 UPPER LANDING PLATE, .25 THICK, ANCHORS TO TOP OF UPPER LANDING FLOOR SURFACE.
 - 4.3 REFER TO ASCENSION CLARITY STRUCTURAL LOADING DOCUMENT FOR STRUCTURAL AND ANCHORING REQUIREMENTS.
5. LIGHTING
 - 5.1 PRIMARY LIGHTING TO BE PROVIDED BY OTHERS IN ACCORDANCE WITH ALL APPLICABLE CODES AND REGULATIONS.
 - 5.2 ACCENT AND AUXILIARY LIGHTING PROVIDED STANDARD ON PLATFORM CONTROLS AND FLOOR.
6. ALTERNATE GATE HINGING AVAILABLE. CONTACT ASCENSION FOR PROJECT-SPECIFIC DRAWINGS.

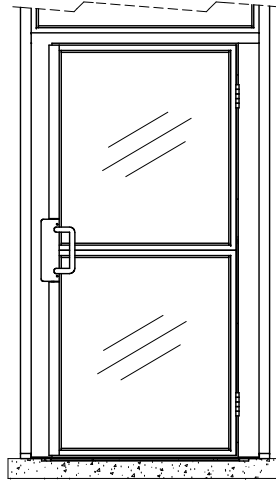
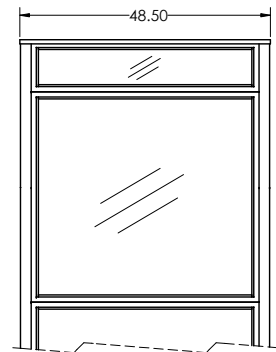

FRONT VIEW

SIDE VIEW

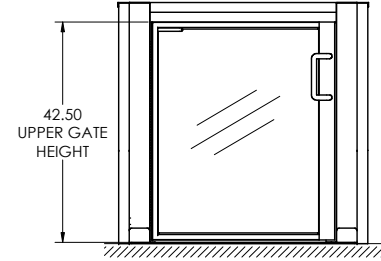
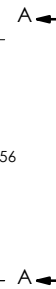

SECTION A-A
VIEW FROM UPPER LANDING

LIFTING HEIGHT:
MINIMUM 35.00
MAXIMUM 168.00

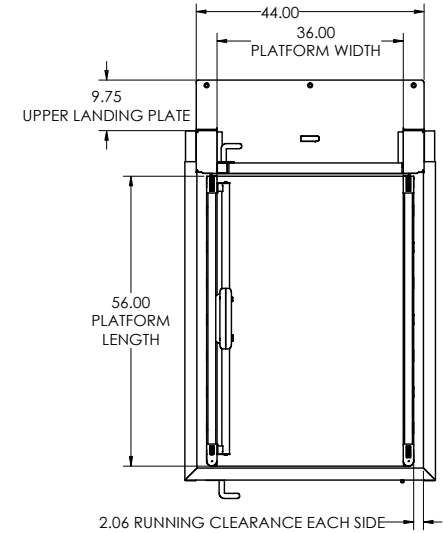

TOP VIEW

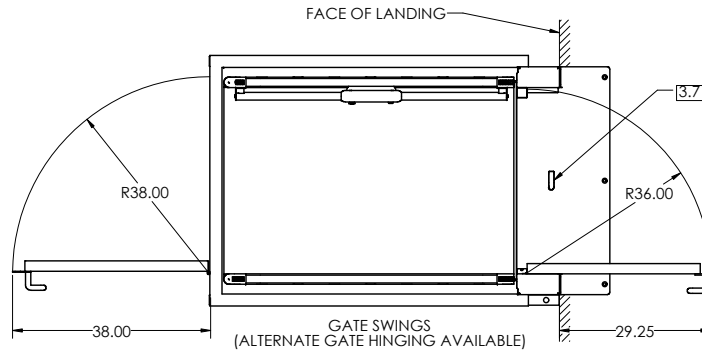

<small>INTERPRET DIMENSIONS AND TOLERANCES (AW ANS Y14.5M-1994 UNLESS OTHERWISE SPECIFIED DIMENSIONS ARE IN INCHES (MM) TOLERANCES ANGLES ± .5° DECIMALS .004 ± .025 XXX ± .125</small>		<small>P.D. BOX 4000 TUCSON, ARIZONA 85717-0000</small>	
DRAWN P. BROBECK	DATE 2-1-16	CLARITY™ VERTICAL PLATFORM LIFT WITH RUNWAY ENCLOSURE	
CHECK APPROVED	APPROVED <i>By Eric Zuercher at 12:18 pm, Mar 31, 2016</i>	FSCM NO. D 08992	DWG. NO. CLARITY 16E
SCALE 1/12	RELEASE DATE	SHEET 1 OF 1	REV